



Secure and Safe

Fire Alarm and Security Systems

www.se-ns.com



**Addressable Resettable Manual Call Point
S6-ACP-300**

Introduction

The S6-ACP-300 Addressable Resettable Manual Call Point is designed to activate manual outputs, including alarms, in addressable systems. The S6-ACP-300 call point is suitable for installation on wall surfaces of floors and corridors in indoor environments, including residential, industrial, and other settings, due to its design.

Installation and Wiring

Various parts of the call point are shown in the picture below.

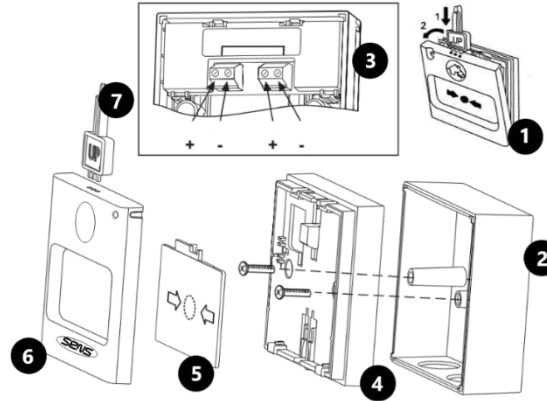

1. Disassemble the frame cover from the body using the provided key, as shown in the figure.
2. Mount the call point base onto the wall using the screws.
3. Connect the loop wires to the corresponding terminals on the element according to their polarity.
4. Attach the middle part to the base using its screws as shown in the schema.
5. Place the call point's unbreakable glass and its spring into their designated positions.
6. Assemble the frame cover onto the other components.
7. If needed, the call point frame cover can be removed using the provided key for maintenance, etc.

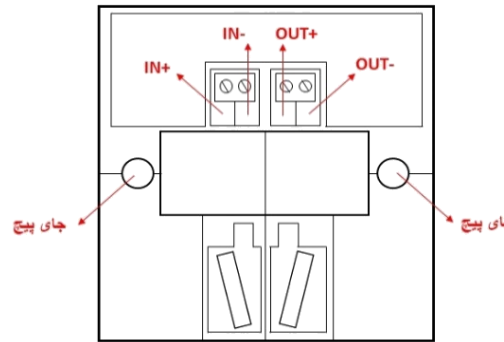

Testing

- Address the S6-ACP-300 manual call point using a handheld programmer.
- Connect the call point to the loop connectors.

- Connect the addressable control panel to a power supply and add the call point to the control panel automatically or manually through the settings section.
- After the control panel recognizes the manual call point, its LED light will start flashing.
- Press the black circle on the call point to activate it, the unbreakable glass will move.
- The call point's LED should stay continuously light up and send a fire signal to the panel.
- Reset the call point by using the provided key to push it back into its original position.
- To clear the fire condition from the panel, the control panel needs to be reset.

Operating Modes	
Normal	The LED blinks.
Alarm	The LED remains continuously lit.
Isolator Active	LED remains continuously lit.

Technical Specifications

Design Standard	EN 54-11
Power Supply Voltage	27V
Stand-By Consumption	1mA @ 27V
Alarm State Current	2mA @ 27V
Operating Temperature	-10 to 70 °C
Humidity	95% non-condensing
Type	Type A (For indoor use)
Dimensions	50×95×95 mm
Weight	130gr

Warranty

Make sure this device is only used with a compatible control panel and no destructive operations are performed on it otherwise, it will not be covered by the warranty. Products must be regularly inspected, serviced, and maintained to ensure proper functionality.

Troubleshooting

If there are any issues with the addressable call point, troubleshooting and repair must be done by the after-sales service department of SENS company, or an authorized representative recommended by the company.

Addressable system zone diagram

